

Sub 4

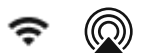

Overview



Sub 4 unlocks the full power of Sonos sound, delivering powerful bass to immerse you even deeper in every scene and song.

- **Pulse-pounding bass.** Dual Sonos-engineered drivers generate deep, dynamic low frequencies. The ported enclosure enhances the bass response so you feel every beat, roar, and rumble in your chest.
- **Transform your home theater experience.** Pair Sub 4 with Sonos Arc, or Beam for dramatically deeper bass and clearer highs that draw you deeper into movies, shows, and games.
- **Bring your music to life.** Hear the nuance in every note and enjoy a greater sense of spaciousness when you pair Sub 4 with Sonos Five, Era 300, or Era 100.
- **Iconic design.** With its elegant sculptural shape and updated matte finish, Sub 4 is designed to look great in your home and to match your Sonos speakers.
- **Place it where and how you want.** Sub 4 reliably connects to your Sonos soundbar or speaker over WiFi so you can place it anywhere in the room—even on its side and under your sofa.

Controls and buttons

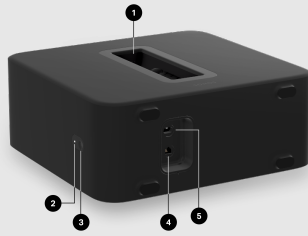

1

Acoustic slot

You can use the acoustic slot as a handle to lift Sub 4.

2

Status light

Displays the product's connection to WiFi, indicates when the volume is muted, and signals errors. [Learn more](#)

If the light is distracting, you can turn it off in your room's settings.

3

Join button

Press to connect during setup.

4

Ethernet port

Use an Ethernet cable if you want to connect to a router (optional).

Use only the supplied power cord to connect to a power outlet (using a third party power cord will void your warranty). Be sure to use the proper power adapter for your country. Push the power cord firmly into Sub 4 until it is flush with the surface.

Select a location

Choose a location—Sub 4 is designed to provide optimal sound wherever you place it.

- Use the acoustic slot as a handle to lift Sub 4 out of the box. You should always bend your knees when lifting heavy objects to avoid undue stress on your back.
- Make sure at least one side of the slot is free from obstruction. If you place it vertically against a wall, don't block the front opening.
- If you place Sub 4 horizontally on the floor, don't put anything on top of it. Leave at least 1" clearance along the top of Sub 4 if placing under furniture.
- Sub 4 is designed to sit on the floor. You can place it in a corner, against the wall, behind, under, or next to any piece of furniture on any kind of floor surface.
- Position Sub 4 either vertically or horizontally. If you're going to use it horizontally, you can attach permanent felt feet.

Connect the cables

1. Attach the power cord and plug in Sub 4. Be sure to push the power cord firmly into Sub 4 until it is flush with the surface
2. Download the [Sonos app](#) from the app store if you don't already have it. You'll use it to set up and control your Sonos system.

Note: Make sure you set up at least one compatible speaker before adding Sub 4.

Sub Audio

Use the Sonos app to adjust **Sub Audio** settings:

1. Go to **System Settings**  and select a room where you've added a Sub.
2. Navigate down to **Sound** and select **Sub Audio**.

Setting	Description
Sub	Toggle On or Off to turn the sound from Sub on and off.
Sub Level	Use the slider to increase or decrease volume. (You can use this setting to match the Sub level to the level of your main speakers.)
Phase Control	Choose 0° or 180° to set the phase control for your Sonos Sub or third-party subwoofer (flip if you don't hear enough bass in your usual listening position). When a room with a Sonos Sub is tuned using Trueplay, phase control is set and can't be changed unless you disable Trueplay.
Reset	Resets all Sub audio settings to their default values (0).

Change speaker pairing

You can easily change the Sonos speaker your Sub 4 is paired with.

Note: If you unplug your Sub from power and plug it back in somewhere else, wait for the status light to stop flashing and turn solid white before changing its settings.

1. Go to **System Settings**  and select a room where you've added a Sub.
2. Navigate to **Products** and select **Remove Sub** to get started.

You can pair the Sub 4 with a different Sonos product or choose not to use it right now. It will appear as "unused" in your list of products until you pair it with another Sonos speaker.

Connect a second Sub

Connect a second Sonos subwoofer to your home theater setup for even deeper, room-filling bass.

In the Sonos app:

1. Go to **System Settings**  and select a room where you've added a Sub.
2. Navigate to **Products** and select **Connect Second Sub** to get started.

Before you start, make sure your subwoofers are compatible with a dual subwoofer home theater setup.

Soundbar**Subs needed**

Arc Ultra

- 2x Sub 4
 - Sub 4 and Sub (Gen 3)
-

Arc or Arc SL

- 2x Sub 4
 - Sub 4 and Sub (Gen 3)
-

Beam (Gen 1 and 2)

- 2x Sub 4
 - Sub 4 and Sub (Gen 3)
-

Ray

- 2x Sub 4
- Sub 4 and Sub (Gen 3)

Specifications

Audio

Amplifiers

Dual Class-D digital amplifiers perfectly tuned to the subwoofer's unique acoustic architecture.

Woofers

Dual 5" x 8" elliptical woofers face inward for a force-canceling effect that virtually eliminates distortion.

Architecture

Ported cabinet enhances bass response.

Frequency response

As low as 25 Hz

EQ

Audio settings automatically equalize to balance Sub 4 and the paired Sonos speaker(s). Use the Sonos app to adjust bass, treble, and loudness.

Trueplay™

This software measures the acoustics of the room then fine-tunes your Sonos system.

Details & Dimensions

Dimensions

Height: 15.31 in (389 mm)
Width: 15.83 in (402 mm)
Depth: 6.22 in (158 mm)

Weight	26 lb (11.79 kg)
---------------	------------------

Colors	Black, White
---------------	--------------

Finish	Matte
---------------	-------

Join button	Press once to add Sub 4 to your system during setup.
--------------------	--

Power & Connectivity

WiFi	Connects to any 802.11a/b/g/n/ac/ax 2.4/5 GHz broadcast-capable router
-------------	--

Ethernet	10/100 port for hardwiring to your router
-----------------	---

Supply voltage	100-240V 50/60Hz
-----------------------	------------------

CPU	Quad Core 4xA55 1.9GHz
------------	---------------------------

Memory	512 MB DDR4 4GB eMMC
---------------	-------------------------

Operating temperature	32°F to 104°F (0°C to 40°C)
------------------------------	-----------------------------

What's in the box?

Sonos Sub 4

Product

Power cable

Length: 6 ft (2 m)

Documentation

Quickstart Guide and legal/warranty information

Requirements

WiFi

Internet connection

Power source

Nearby electrical outlet

Sonos app

The latest generation of the Sonos app running on a compatible device

Sonos product

An amplified non-portable product, such as Arc Ultra or Era 300

Important safety information

1. Lies diese Anweisungen durch.
2. Bewahre diese Anweisungen auf.
3. Beachte alle Warnungen.
4. Befolge alle Anweisungen.
5. Verwende dieses Gerät nicht in der Nähe von Wasser.
6. Reinige das Gerät nur mit einem trockenen, weichen Tuch. Haushaltsreiniger oder Lösungsmittel können die Oberfläche deiner Sonos Produkte beschädigen.
7. Blockiere keine Lüftungsöffnungen. Installiere das Gerät gemäß den Anweisungen des Herstellers.
8. Installiere das Gerät nicht in der Nähe von Wärmequellen wie Heizkörpern, Heizregistern, Öfen oder anderen Vorrichtungen, die Wärme erzeugen.
9. Sorge dafür, dass niemand auf das Stromkabel treten kann und dass es nicht eingeklemmt wird. Dies gilt insbesondere in der Nähe des Steckers, bei Mehrfachsteckdosen sowie am Austrittsort des Kabels vom Gerät.
10. Verwende nur die vom Hersteller angegebenen Anschlussgeräte und Zubehörteile.
11. Trenne das Gerät bei Gewittern oder längeren Nutzungspausen vom Stromnetz.
12. Dieses Produkt beinhaltet keine Teile, die vom Nutzer gewartet werden können. Öffne und demontiere keine Komponenten und versuche auch nicht, Komponenten zu reparieren. Lasse alle Wartungsarbeiten von qualifiziertem Sonos Servicepersonal durchführen. Eine Wartung ist erforderlich, wenn das Gerät in irgendeiner Weise beschädigt wurde, z. B. wenn das Stromkabel oder der Netzstecker beschädigt ist, Flüssigkeit oder Gegenstände in das Gerät gelangt sind, das Gerät Regen oder Feuchtigkeit ausgesetzt war, nicht normal funktioniert oder fallengelassen wurde.
13. Der Netzanschluss sollte gut zugänglich sein, um das Gerät jederzeit von der Stromversorgung trennen zu können.
14. **Warnung:** Setze das Gerät nicht Regen oder Feuchtigkeit aus, um das Risiko eines Brandes oder Stromschlags zu reduzieren.

15. Sorge dafür, dass keine Flüssigkeiten auf das Gerät tropfen oder spritzen, und stelle keine mit Flüssigkeit gefüllten Behälter, wie z. B. Vasen, auf dem Gerät ab.